



RemoteLync Home Security Camera #21026665



When motion is detected, the RemoteLync Home Security Camera app sends an alert to your mobile device and to the people in your network. At the same time, the camera sounds an alarm, light is activated and starts recording video and will continue recording so long as it senses motion in your home. After receiving an alert, you and your network can view video of the incident and decide to dismiss the alert or take action.

- **MOVE BEYOND STREAMING** Camera utilizes Wi-Fi so it doesn't have to stay plugged in.
- **GEO-ARMING** Automatically arm and disarm your home when you leave and return using an intelligence geo-fence. (Siren and light can be deactivated in the app. Video clips are set at increments of 5, 10, 20 and 30 seconds).
- **CREATE A NETWORK** Invite trusted friends and family to help protect your home.
- **NOTIFICATION OPTIONS** Alerts you in the way want. Whether it is a notification to your mobile device or using the IFTTT integration to receive email, phone or Facebook messages.
- **INSTALLS EASILY. NO MONTHLY FEES** A self contained security system that runs on your existing Wi-Fi network. It is completely wire free and requires no additional hardware.
- **MOUNTS MAGNETICALLY, ANYWHERE - PIVOTS AND POINTS IN ANY DIRECTION** Camera is anchored to its base with magnets, making it easy to remove when recharging or repositioning.
- **RECHARGE IT ONCE A QUARTER - OR LESS** Lasts three months on a single charge.

Dimensions: 2.583" diameter
1 year warranty

Watch what
matters most to you!



RemoteLync Smart Home Monitor #21026465



RemoteLync notifies homeowners of a home emergency when they're away- offering peace of mind. Ideal for primary residence, vacation home or rental property. The device plugs into a single outlet, listens for a smoke or carbon monoxide alarm and uses the home's Wi-Fi to remotely alert the homeowner on iOS® and Android™ compatible phones and tablets.

- **INSTALLS EASILY NO MONTHLY FEES** Works with a home's existing alarms and Wi-Fi and does not require additional products.
- **PATENTED TECHNOLOGY** Distinguishes smoke and carbon monoxide alarms from background noise to reduce the chance of a nuisance alarm.
- **CREATE A NETWORK** When an alarm triggers the device, RemoteLync communicates via a free app that can be customized to notify an entire network, including neighbors and family, the option to dial 911.

Dimensions: 2.25" square
1 year warranty

Remote Monitoring - Why it's needed:

A home fire happens every 70 seconds in the U.S. With RemoteLync, homeowners can enjoy peace of mind knowing that their homes' smoke and carbon monoxide alarms are being monitored while they're away - 24 / hours day, 7 / days week.



Class A

- trash, wood, paper, cloth



Class B

- flammable liquids, gases, solvents



Class C

- electrical equipment

According to the National Fire Protection Association (NFPA), someone in the United States dies in a house fire every three hours, averaging approximately 3,000 deaths each year.



Kitchen Extinguisher #21006206

- 1.5 lbs. of fire extinguishing agent
- UL rated 2-B:C
- Powder coated cylinder for corrosion protection
- Effective on flammable liquids and electrical fires
- One touch pressure check device
- Easy-to-pull safety clip
- 2 year limited warranty
- Single use fire extinguisher

Applications: kitchen
Dimensions: 10"H x 2.9"W



Kitchen Extinguisher* #21008173

- 2.5 lbs. of fire extinguishing agent
- UL rated 711A - **The only fire extinguisher UL-Listed for residential cooking equipment**
- Powder coated cylinder for corrosion protection
- Effective on flammable liquids
- The proprietary nozzle design (patent pending) allows a broad, dispersed discharge of agent that delivers a high volume, low velocity delivery of dry chemical
- Pressure gauge provides at-a-glance status
- Easy-to-pull safety clip
- Wall hanger included
- 12 year limited warranty
- Single use fire extinguisher

Applications: kitchen
Dimensions: 13.75"H x 3.25"W



Full Home Extinguisher #466142

- 2.5 lbs. of fire extinguishing agent
- UL rated 1-A, 10-B:C
- Powder coated cylinder for corrosion protection
- Effective on paper, flammable liquids and electrical fires
- Pressure gauge provides at-a-glance status
- Easy-to-pull safety clip
- Strap bracket included
- 6 year limited warranty
- U.S.C.G (Coast Guard), DOT approved
- Single use fire extinguisher

Applications: residential use
Dimensions: 13.75"H x 3.25"W



* The majority of house fires start in the kitchen. But with the right fire extinguisher on hand they could end there, too. Kidde now has **THE ONLY UL-LISTED KITCHEN FIRE EXTINGUISHER** that is approved for use with residential cooking equipment.



Basic Extinguisher #21005944

- 1.5 lbs. of fire extinguishing agent
- UL rated 5-B:C
- Powder coated cylinder for corrosion protection
- Effective on flammable liquids and electrical fires
- Pressure gauge provides at-a-glance status
- Easy-to-pull safety clip
- Strap bracket included
- 5 year limited warranty
- Single use fire extinguisher

Applications: residential use
Dimensions: 10.95"H x 3.25"W







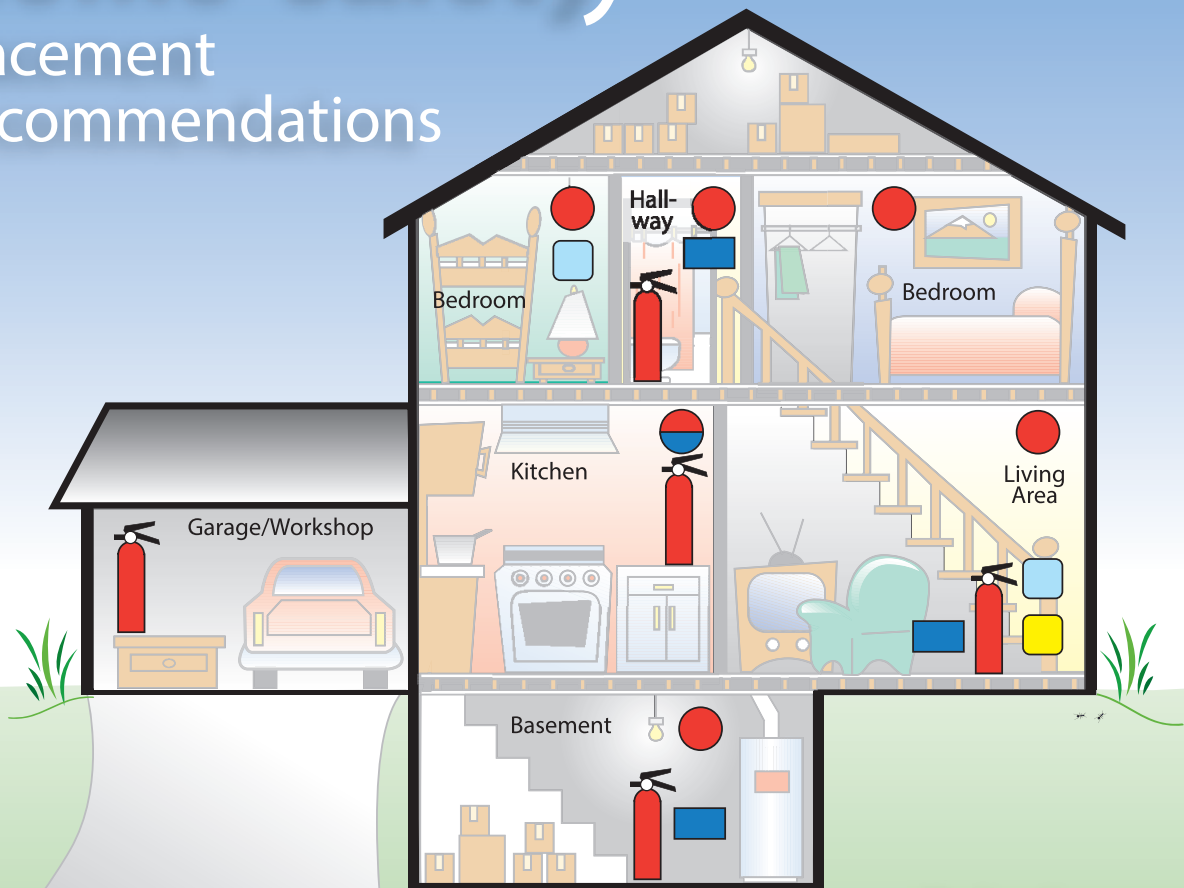

All fire extinguishers on this page can be customized. Please call for imprinting options.

Home Safety

Placement Recommendations



-  Smoke Alarm
-  Carbon Monoxide Alarm
-  Combination Alarm

-  RemoteLync Camera
-  RemoteLync Monitor
-  Fire Extinguisher

Technology
that saves
Lives



According to the National Fire Protection Association - there were **1,298,000** total fires reported during 2014 in the United States. It is up **4.7%** from 2013. There were **3,275** civilian fire deaths and **15,775** civilian fire injuries. Resulting in **\$11.5 billion** in property damage. A fire department responded to a fire every **24 seconds**.

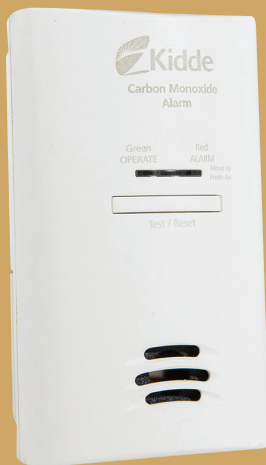

Basic Carbon Monoxide Alarm #21025759

- **2 AA Battery Backup** – Protects even during power outages (batteries included)
- **Low Battery Hush** – Silences low battery chirp warning for up to 12 hours
- **Event Memory** – If the unit has detected CO concentrations of 100ppm or greater, the green LED will flash every 10 seconds.
- **Battery Pull Tab** – Eliminates battery installation time
- **Loud 85 Decibel Alarm** – Alerts of deadly CO gas
- **Test/Reset Button** – Tests the alarm electronics and resets the unit during alarm
- **LEDs** – A green light for normal condition and a red light for alarm condition
- **Tamper Resist Feature** – Alerts you if it has been unplugged or has come loose from the outlet
- **UL Listed** – Listed by UL as a single station carbon monoxide alarm
- 10 year limited warranty

Dimensions: 2.75"L x 4.5"H x 1.5"D



Battery Operated Carbon Monoxide Alarm #9C05LP2

- **2 AA Battery Backup** – Protects even during power outages (batteries included)
- **Low Battery Hush** – Silences low battery chirp warning for up to 12 hours
- **Low Battery Signal** – Alerts user when the batteries need to be replaced
- **Event Memory** – If the unit has detected CO concentrations of 100ppm or greater, the green LED will flash every 10 seconds
- **Loud 85 Decibel Alarm** – Alerts of deadly CO gas
- **Test/Reset Button** – Tests the alarm electronics and resets the unit during alarm
- **LEDs** – A green light for normal condition and a red light for alarm condition
- **UL Listed** – Listed by UL as a single station carbon monoxide alarm
- 10 year limited warranty

Dimensions: 4.5"L x 2.75"H x 1.5"D



10 Year Sealed Battery Carbon Monoxide Alarm #21010073

- **Sealed-in Lithium Battery** – No battery replacement required over the 10 year life of the alarm
- **Self Activation** – Alarm automatically activates when attached to the mounting bracket
- **Test/Reset Button** – Tests the alarm electronics and resets the unit during alarm
- **Green LED** – Flashes every 30 seconds to indicate the unit is operating properly
- **Red LED** – A dangerous level of carbon monoxide is detected the red LED will pulse and alarm will sound
- **Amber LED** – Flashes every second to indicate the unit is in fault mode
- **Event Memory** – Red LED flashes every 60 seconds to alert that a high level of carbon monoxide has been detected within the last 14 days
- 10 year limited warranty

Dimensions: 4.5"L x 2.75"H x 1.5"D

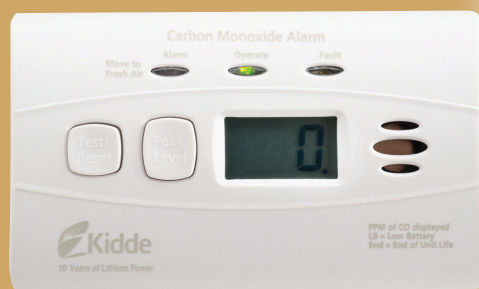

Digital Display 10 Year Sealed Battery Carbon Monoxide Alarm #21010075

- **Sealed-in Lithium Battery** – No battery replacement required over the 10 year life of the alarm
- **Self Activation** – Alarm automatically activates when attached to the mounting bracket
- **Peak Level Memory** – Displays the highest CO concentration measured since the last reset
- **Test/Reset Button** – Tests the alarm electronics and resets the unit during alarm
- **Green LED** – Flashes every 30 seconds to indicate the unit is operating properly
- **Red LED** – A dangerous level of carbon monoxide is detected the red LED will pulse and alarm will sound
- **Amber LED** – Flashes every second to indicate the unit is in fault mode
- 10 year limited warranty

Dimensions: 4.5"L x 2.75"H x 1.5"D



Combination Carbon Monoxide and Smoke Alarm #900-0102

- **Ionization Smoke Alarm Sensor** – Protects best against fast flaming fires
- **2 AA Battery Operated** – Protects even during power outages (batteries included)
- **Battery Safeguard** – The battery door will not close unless the batteries are properly installed
- **Voice Alarm** – Announces "Fire!" when a smoke or fire hazard is detected and announces "Warning Carbon Monoxide" when a CO hazard is detected.
- **Test/Reset Button** – Tests alarm circuitry and triggers the voice announcement
- **LEDs** – Flashing green for normal operation and flashing red for alarm condition
- **Low Battery Warning** – The unit warns of a low battery condition by announcing "low battery" and by initiating an alarm chirp and activating a flashing red LED
- **Hush® Feature** – Temporarily silences nuisance alarms
- 10 year limited warranty

Dimensions: 5.6" diameter



Dual Sensor Alarm #442007

- **Dual Sensor** - Contains both a photoelectric and ionization sensor
 - Ionization Sensor - may detect invisible fire particles (associated with flaming fires)
 - Photoelectric Sensor - may detect visible particles (associated with smoldering fires)
 - **9V Battery Operated** - Protects even during power outages (battery included)
 - **Test/Reset Button** - Tests unit's circuitry and horn
 - **LED** - A red indicator light will flash once every 30-40 seconds for normal operation
 - **Tamper Resist Feature** - Deters from tampering or theft
 - **Hush® Feature** - Temporarily silences nuisance alarms
 - **Easy to Install** - No wiring needed
 - UL Listed
 - 10 year limited warranty
- Dimensions: 5.75" diameter



10 Year Sealed Battery Smoke Alarm with Hush™ #900-0136-003

- **Ionization Sensor** - Protects best against fast flaming fires
 - **Sealed-in Lithium Battery** - No battery replacement required over the 10 year life of the alarm
 - **Test/Reset Button** - Tests unit's circuitry and resets memory after alarm condition occurs
 - **LED** - A flashing red indicator light with four modes of operation: standby, alarm, hush and memory set
 - **Tamper Resist Feature** - Deters from tampering or theft
 - **Hush® Feature** - Temporarily silences nuisance alarms
 - **Self Activation** - Alarm automatically activates when attached to the mounting bracket
 - **Alarm Memory** - Rapidly flashing LED alerts user if the alarm has sounded since the last time the test/reset button was used
 - **End of Life Warning** - Alarm chirps every 40-45 seconds, indicating alarm needs replacing
 - UL listed
 - 10 year limited warranty
- Dimensions: 5.6" diameter



Front Loading Battery Operated Smoke Alarm #i9070

- **Ionization Sensor** - Protects best against fast flaming fires
 - **9V Battery Operated** - Protects even during power outages (battery included)
 - **Front Loading Battery Door** - Change battery without removing alarm from mounting bracket
 - **Test/Reset Button** - Tests unit's circuitry, horn and battery function
 - **LED** - A red indicator light will flash once every 30-40 seconds for normal operation
 - **Tamper Resist Feature** - Battery door can be locked to prevent battery removal
 - **Hush® Feature** - Temporarily silences nuisance alarms
 - **Adjustable Mounting Bracket** - Allows for fast and easy installation
 - UL listed
 - 10 year limited warranty
- Dimensions: 5" diameter



Fire Sentry Smoke Alarm #i9040

- **9V Battery Operated** - Protects even during power outages (battery included)
- **Low Battery Indicator** - Low battery warning chirp alerts user to change battery
- **Test Button** - Tests unit's electronic circuitry, horn and battery function
- **Discreet Design** - 4" diameter
- **Easy Installation** - no wiring needed
- UL listed
- 3 year limited warranty



CAN BE CUSTOMIZED

Kidde items can be customized.
Please call for imprinting options.

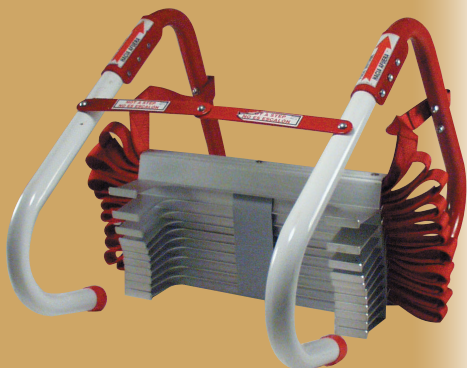

Bedroom Smoke Alarm with 10 Year Sealed Battery and Voice Alarm #21010067

- **Photoelectric Sensor** – Detect visible particles (associated with smoldering fires)
 - **Sealed-In Lithium Battery** – No battery replacement required over the 10 year life of the alarm
 - **Voice Alarm** – Announces “Fire! Fire!” in addition to loud 85dB beeps when smoke or fire is detected
 - **Test/Hush Button** – Tests alarm circuitry and activates Hush features
 - **Smart Hush™** – Temporarily silences nuisance alarms for approximately 10 minutes
 - **LED** – Red LED will blink in conjunction with the alarm sound
 - **Self Activation** – Alarm automatically activates when attached to the mounting bracket
 - **Alarm Memory** – Rapidly flashing LED alerts user if the alarm has sounded since the last time the test/reset button was used
 - **End of Life Warning** – Alarm chirps every 30 seconds to indicate the unit is in need of replacement
 - **End of Life Hush®** – End of life indication can be silenced three days at a time
 - UL Listed
 - 10 year limited warranty
- Dimensions: 5.22” diameter

Escape Ladder #468093 (2 story, 13 feet)

- **Worry-free Escape** - Strong and durable construction
- **Easy to Use** - Attaches quickly to most common windows
- **Tangle-free Design** - Fast and easy to deploy
- **Ready for Use** - No tools or assembly required
- Ladder tested to 1,000 lbs.
- Anti-slip rungs
- Fits under the bed or in a closet near the window
- Designed for a one time use
- 5 year limited warranty

Basic Home Safety Kit #HS7

model #21005944 - Basic Fire Extinguisher
model #9C05LP2 - Battery Operated Carbon Monoxide Alarm
model #i9040 - Fire Sentry Smoke Alarm

Home Safety Kit #PKD15609

model #21026465 - RemoteLync Smart Home Monitor
model #21005944 - Basic Fire Extinguisher
model #9C05LP2 - Battery Operated Carbon Monoxide Alarm
model #900-0136-003 - 10 Year Sealed Battery Smoke Alarm with Hush™

Carbon Monoxide Home Safety Kit #PKD15792

model #21026359 - Bedroom Plug-In Carbon Monoxide Alarm
model #21026365 - Hallway Plug-In Carbon Monoxide Alarm
model #21026350 - Living Area Plug-In Carbon Monoxide Alarm

- **10 Year Sealed Lithium Battery** – No battery replacement required over the 10 year life of the alarm
- **Digital Display** – Displays the level of CO the unit is sensing
- **Peak Level Button** – Displays the highest level of CO recorded since last reset
- **Test/Reset Button** – Tests the unit for proper operation and resets the Carbon Monoxide alarm
- **10-Year End of Life Warning** – Alerts user to replace CO alarm after 10 years of operation
- **Rotating AC Blades** – Unit remains vertical whether electrical socket is in vertical or horizontal orientation
- **Voice Alarm** – Communicates verbal warning once CO levels reach 100ppm (model #21026359 only)
- **Night Light/Escape Light** – LED provides automatic illumination in dark conditions, bright intensity during alarm situation to help evacuate rooms (model #21026365 only)
- UL Listed
- 10 year limited warranty

KeySafe™

Portable Stor-A-Key™

#001860 (blue)

#001941 (yellow)

- Locking key case with resettable combination and adjustable cable
- Adjustable cable hooks almost anywhere - hose bib, chain link fence, pipes, backpack/bag, shed, car/bike rack and more
- Foam insert can be removed to hold keys, cash and more



Keep your keys where you need them with Stor-A-Key™. Whether you are planning a trip away from home, ensuring emergency access, storing spare keys or simply keeping your key accessible for all family members, the Stor-A-Key™ cases give you quick and convenient access to your keys where you need it.

No Lockouts Attach the magnetic Stor-A-Key™ to boats, RVs or other vehicles to keep keys secure and available

No Lost Keys Attach your keys safely inside your packs and bags so they won't fall out

Hands Free Lock your keys at your vehicle when you need to carry as little gear as possible



Locking Stor-A-Key™ #001859

- Locking key case with resettable combination and powerful magnet
- Spare key storage for auto, home, boat, office files, etc.
- Attach Locking Stor-A-Key™ anywhere using magnet or adhesive metal plate (included)
- Easy key retrieval and foam insert keep key from falling out
- Equipped with anchor point for strap or cable tie



**CAN BE
CUSTOMIZED**

KeySafe™ items can be customized.
Please call for imprinting options.





KeySafe Auto #001324

- Locking key case with pushbutton faceplate. Just change the code when you need to change access to your keys
- Permanently mounted key storage includes a protective weather cover and 4 self-tapping screws
- Mount in wheel well, on frame, tow hitch, trailer tongue and more
- Vehicle keys will be there when needed
- Cover protects from road grime and debris (snow, ice, salt)



white

KeySafe Original (Slimline)

#001413 (white)

#001414 (clay)

#001170 (titanium)

- Locking key case with pushbutton faceplate. Just change the code when you need to change access to your keys
- Attaches to any wall or flat surface with mounting hardware included
- The interlocking faceplate prevents tampering and unauthorized access
- Family members - after school access for children with no more lost keys
- Temporary access - schedule service and just change the code when the job is done
- Caretaker entry - provide caretakers access for elderly residents, pets or children



clay



titanium



8

KeySafe Original (Portable) #001406

- Locking key case with pushbutton faceplate. Just change the code when you need to change access to your keys
- Hangs easily on doorknob, fence, railing or pipe
- Just open the lid, lift the shackle and hang - no tools necessary
- Constructed of sturdy metal with protective rubber shell
- Guaranteed to never rust
- Routine maintenance - provides scheduled access for cleaning staff, pool service and household maintenance
- Remote locations - access to vacation properties and rentals